

A technical drawing of a mechanical component, likely a shaft or housing, shown in cross-section. The drawing includes several dimension lines and labels:

- H2**: Total height of the component.
- C2**: Height of the central section.
- H3**: Height of the top flange.
- ØN1**: Outer diameter of the top flange.
- ØA**: Inner diameter of the top flange.
- S**: Thickness of the top flange.
- R1**: Radius of the fillet transition between sections.
- ØL**: Diameter of the fillet transition.
- f1**: Fillet radius at the bottom right corner.
- ØK**: Diameter of the central section.
- ØD**: Overall outer diameter of the component.

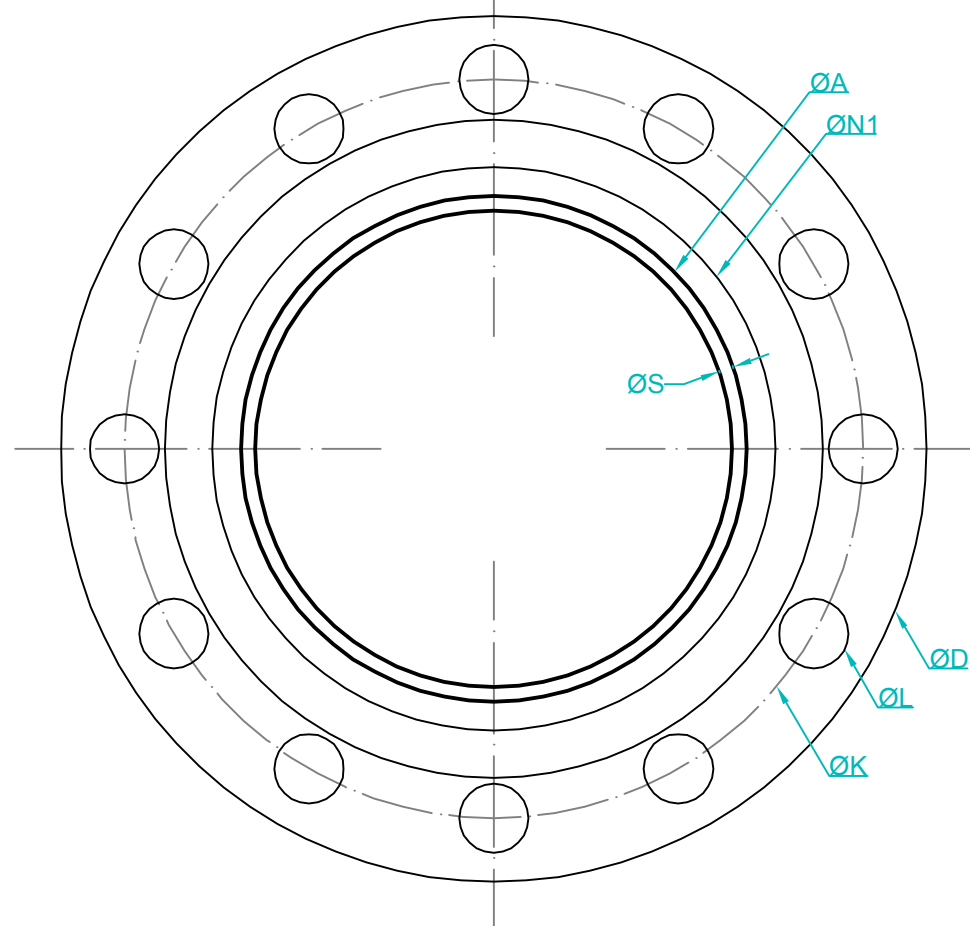

**Nota:**  
Flansa conf. SR EN 1092-1+A1:2013

Dimensiuni montare														
DN	Diametre			Suruburi		Diametru exterior gat sudabil	Grosime	Suprafata	Masura		Diametru gat de baza	Raza	Grosimea gatului	Masa net
mm	Exterior (mm)	Cerc surub	Gaura surub	Nr.	Tip	mm	mm	mm						
	D	K	L			A	C2	f1	H2	H3	N1	R1	S	Kg
250	470	400	36	12	M33	273,1	46	2	125	18	316	12	8.8	48.30